



Code : **4950**

Mutto Optronics Corporation *--Contribute to the beautiful
experience of scientific and technological life.*

reporter: YVES S. Y. LIAW General manager

Company briefing

2021/06/09

Disclaimer

Here is a statement regarding the content of the company's performance report. In addition to past confirmed events and data, it also includes some texts that are optimistic and forward-looking; these optimistic and forward-looking texts and descriptions are based on some assumptions and risk and Uncertainty assessment and prediction, these assumptions may affect the uncertainty of future results and possible investment risks.

Mutto Optronics Corporation Introduction

In 2008, it was established. Mainly engaged in the research and development, production and sales of touch panels.

In 2012, the stock was listed on the OTC (4950).

In 2014, adjusted its main business and sold the Touch Control Suzhou plant to China Dongshan Precision.

In 2014, it acquired Shanghai Sihe Precision and established a stainless steel business office.

In December 2020, the Optoelectronics Division was established to focus on highlighting touch displays for special applications.

Capital: 457.79 million NTD

Organizational Structure



Dual business model

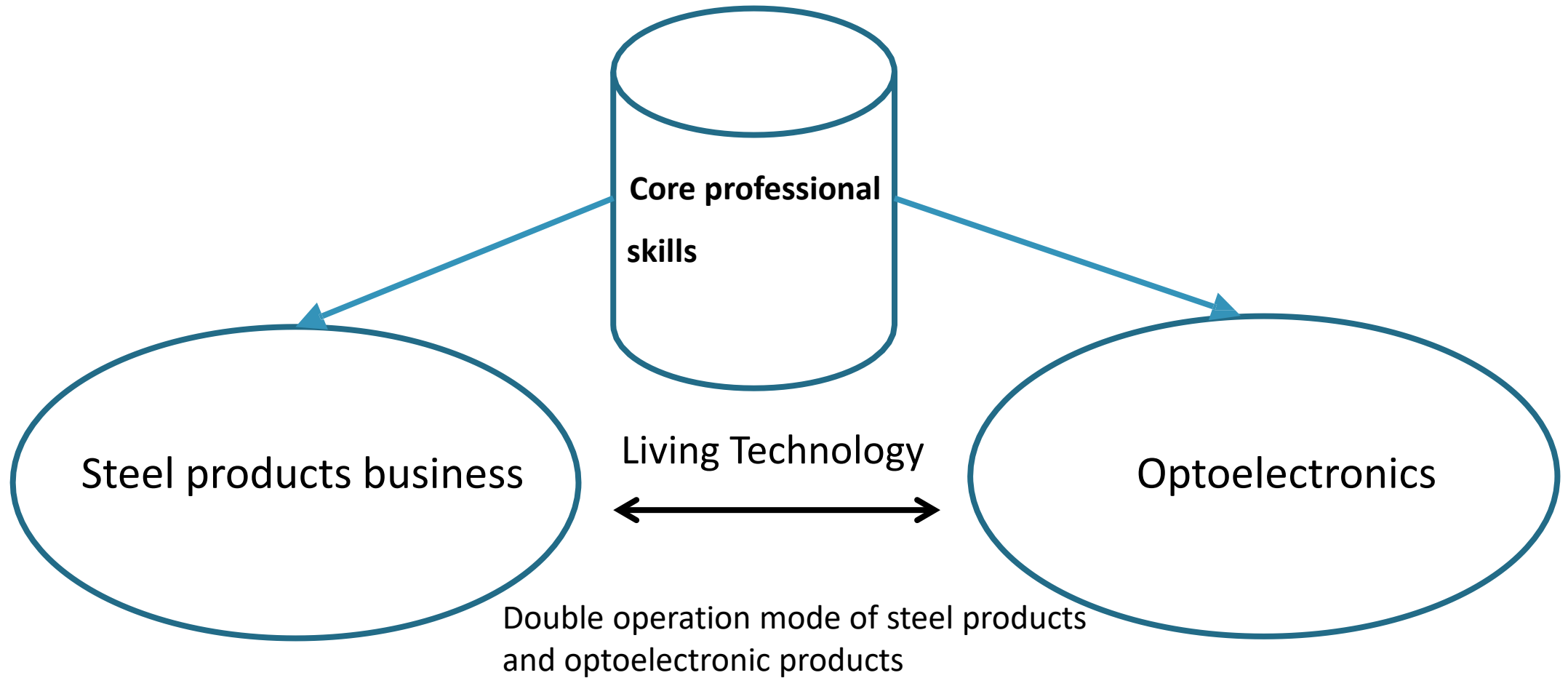

Steel Products Division-Nantong Sihe

Location: Nantong High-tech Zone Area:
20000 square meters Employees: 144
Customers: 20 international customers
Capacity: 10 million tools/year



Steel product quality system certification

Producer : Nantong Shear Stainless Steel Products Co., Ltd.
0510-88495 and mobile 131-5260511 Audit Date: 24/10/2018 Audit Type: Full Audit

amfori BSCI
Trade with purpose

Auditee	Nantong Shear Stainless Steel Products Co., Ltd.
Audit Date From :	24/10/2018
Audit Date To :	25/10/2018
Expiry Date of the Audit :	Please refer to the producer profile in the amfori BSCI platform
Auditing Company :	SGS
Auditor's Name(s) :	Judy Kullend
Auditing Branch (if applicable) :	SGS CHINA

amfori BSCI
 Trade with purpose

This is an extract of the on line Audit Report. The complete report is available in the amfori BSCI Platform. Access: www.bsciplatform.org. For certified users only.

All rights reserved. No part of this publication may be reproduced, stored in a retrieval system, or transmitted, in any form or by any means, electronic, mechanical, photocopying, recording or otherwise, without written permission from the publisher.

This is an extract of the amfori BSCI Audit Report, which is available in the amfori BSCI Platform. © amfori, 2018. The English version is the legally binding one.

amfori BSCI | www.bsciplatform.org | Page 1/16
Generated on: 24/10/2018

BSCI

NSF ISR

Certificate of Registration

This certifies that the Quality Management System of

Nantong Sheaffer Manufacturing Co., Ltd.

Unified Social Credit Code: 9132062MA1P43A67
 Business address: 899#, Jinxi Road, Jintu Town, Tongzhou District, Nantong City, Jiangsu Province, China 226399
 Registered address: East of Jinxi Road, South of Zhaoxia Road, Nantong New and High-tech Industrial Development Area, Tongzhou District, Nantong City, Jiangsu Province, China 226399

has been assessed by NSF-ISR and found to be in conformance to the following standard(s):

ISO 9001:2015

Scope of Registration:
 Manufacture of Stainless Steel Tool

Exclusions: Product Design

ANAB IAF

Certificate Number: CNQMS033154
 Certificate Issue Date: 10-MAY-2018
 Registration Date: 10-MAY-2018
 Expiration Date*: 09-MAY-2021

Carl Black,
 Director- Technical Operations &
 Business Units, NSF-ISR, Ltd.

The certificate information can be searched on the website of CNCA (www.cnca.gov.cn).
 The certified organization must do the regular surveillance audit and get valid audit conclusion to maintain the effective of the certificate.

NSF International Strategic Registrations
 789 North Dearborn Road, Ann Arbor, Michigan 48106 | (800) NSF-8000 | www.nsf-isr.org

Authorized Registration and/or Accreditation Mark. This certificate is property of NSF-ISR and must be treated accordingly.
 *Expiry is subject to performance of regular audits. For each registration renewal (RMR) before or after the end of the year and on day.

ISO 9001:2015

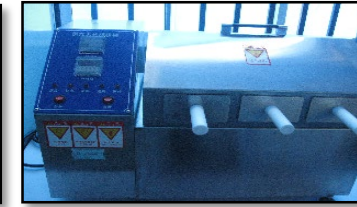
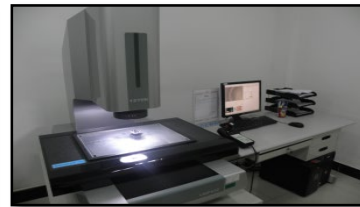

Steel related patents

Invention patents: 5 items

Utility patents: 11 items

Appearance patent: 3 items

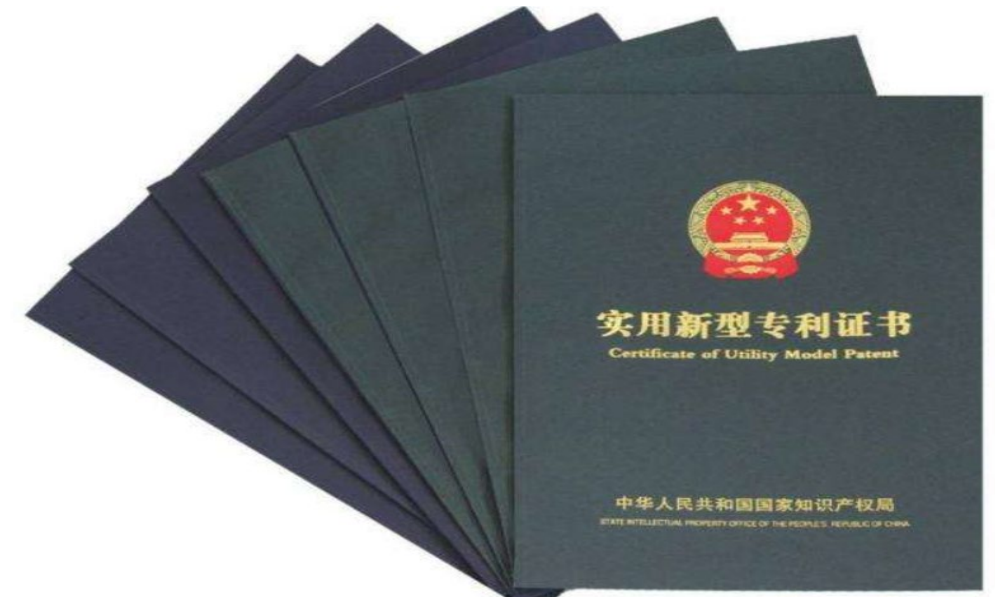
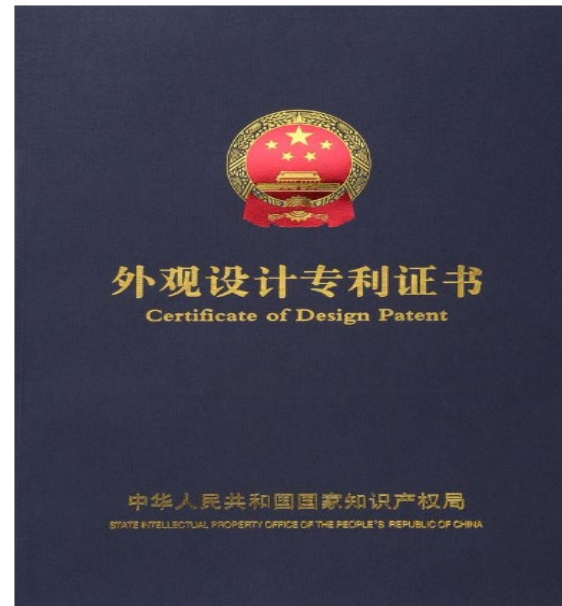

Mutto Steel Products-Core Value

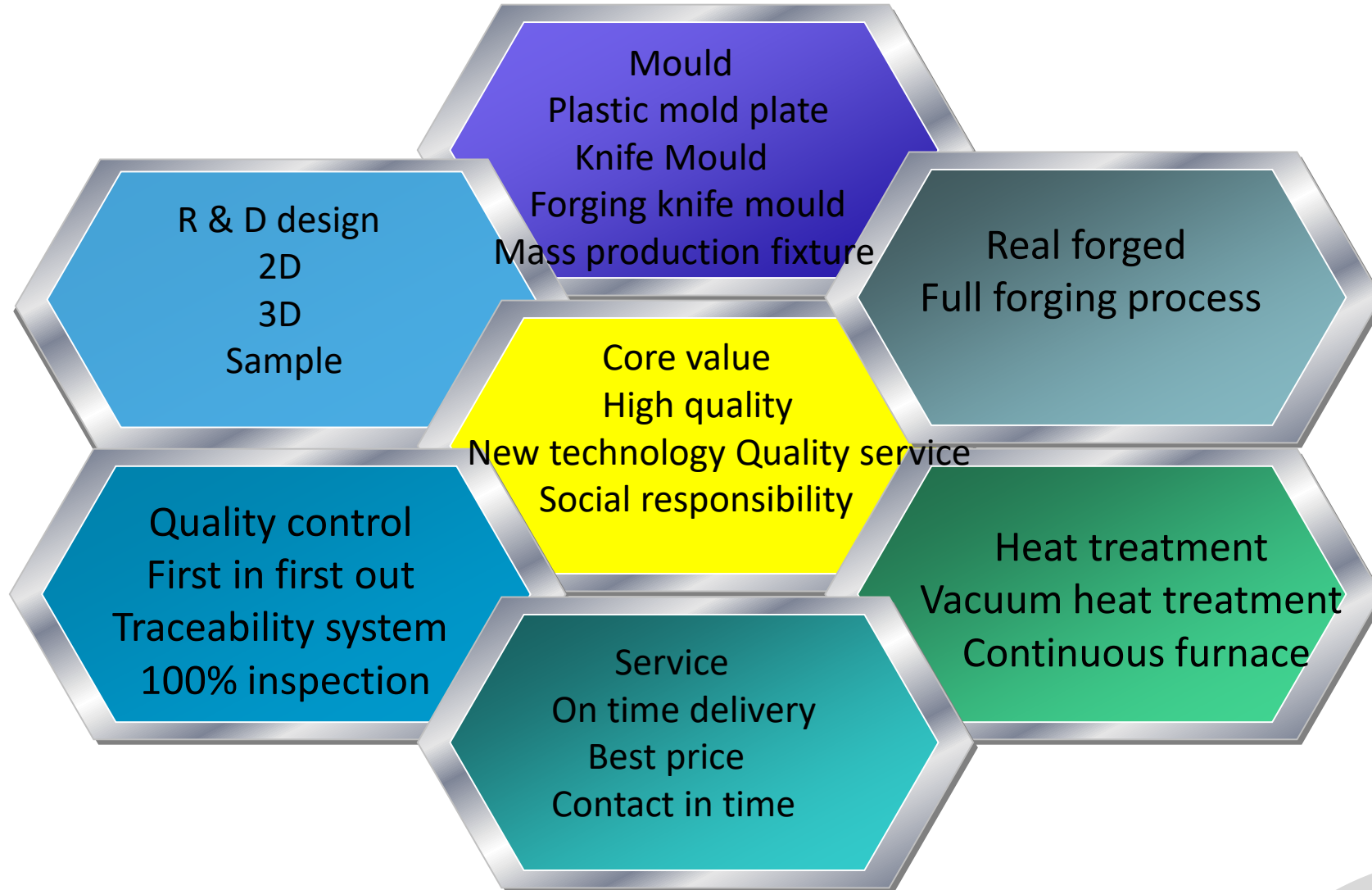

Main features of the product

Full forged

Fully forged and integrated

Flat forging

Forging the joint between the blade and the handle to ensure strength

Flat knife

The blade and the handle are welded to form



Main advantages of steel products

1



Anti-bending knife test

we guarantee that it can withstand the bending test to ensure the strength of each tool



Cutting test

we use several processes to verify the durability and sharpness of the tool.



Balance test

each tool and the sense of balance play a vital role in the long-term comfort of the knife user.

Main advantages of steel products 2

One piece

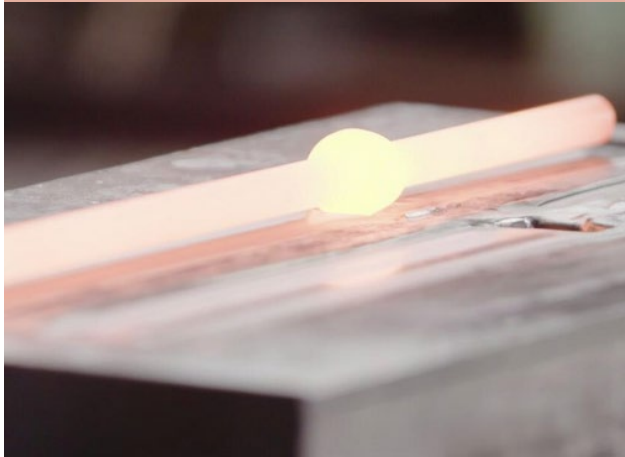

The whole knife is heated and forged



Toughness



Extreme bending, not easy to break the knife

Production process: heating and forging processing of stainless steel bars / changing the direction of metal lattice arrangement, increasing mechanical properties / having tensile strength and ductility

➡ High process technology threshold

Steel Product Catalog 1

Classic

Fiberglass-reinforced poly resin handle ensures the highest standards of kitchen hygiene, which is durable and commonly used in higher end knives. Will not absorb moisture, crack, split or chip. Will not support bacteria growth.



F1115B- Traditional Real Forged 15 pc set

The Classic series is the most traditional design of forged knife which composes of optional 1.4116 German Steel blade or 420J2 Japanese steel, three rivets and black POM handle.

This is the must-have for any family who require a great tool for their daily cooking. With the delicate forging process and enhanced ice-hardening treatment, knives in this series are ensured to have the best performance in handling and ultimate durability for home-use.



F11-2L L-Chef knife
10 Inch Length 3.0 mm thickness



F11-2 Chef knife
8 Inch Length 3.0 mm thickness



F11-1L L-Slicer/Carving knife
10 Inch Length 3.0 mm thickness



F11-1 Slice/Carving knife
8 Inch Length 3.0 mm thickness



F11-15A Santoku knife
7 Inch Length 2.5 mm thickness



F11-15B Mini Santoku knife
5 Inch Length 2.0 mm thickness



F11-2s Mini Chef knife
6 Inch Length 2.5 mm thickness



F11-6 Bonning knife
5 Inch Length 1.6 mm thickness



F11-8A Utility knife
6 Inch Length 1.6 mm thickness



F11-9 Steak knife
5 Inch Length 1.6 mm thickness



F11-10 Paring knife
3.5 Inch Length 1.6 mm thickness



Steel Product Catalog 2

Perfect

Core VG-1 steel blade is made by super hard alloy. The hardness of knife blade is reached 60 HRC. It has superior abrasion resistance and offers you the best sharpness and long lasting sharpness, which is real finished blade by skilled workman.



WV100-08B Damascus 8 pieces set (67Layers)

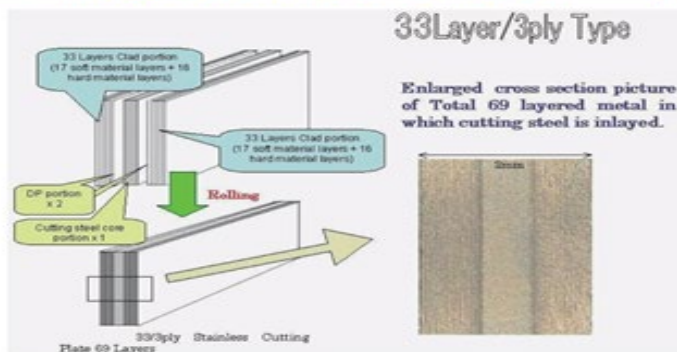

33Layer/3ply Type

Enlarged cross section picture of Total 69 layered metal in which cutting steel is inlayed.



WV100-2 Chef knife

8 Inch Length 2.2 mm thickness

WV100-1 Slicer/Carving knife

8 Inch Length 2.2 mm thickness

WV100-5 Bread knife

9 Inch Length 2.2 mm thickness

WV100-8 Utility knife

5 Inch Length 1.5 mm thickness

WV100-10 Paring knife

3.5 Inch Length 1.5 mm thickness

Damascus

With the specially made 33 layers of stainless steels, the Damascus series has the most elegant and sharpness knives ever made for home or professional uses. The eye-catching feature on the appearance of this series knife is that there will be unique pattern all over the blade for each knife. Sheaffer uses the highest quality from Japanese special steel maker, to ensure the unbeatable durability and noble appearance of this series.

Furthermore, with the Rockwell hardness of the core stainless steel rated at 60 HRC, it is the sharpest and hardest knife on the market. Therefore, we can guarantee the knives in this series are the top of the line quality and will serve you well much longer than other knives on the market.

Steel Product Catalog 3

Zoom

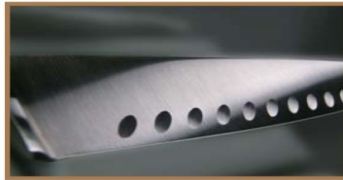

Surface : Oblique Dimple

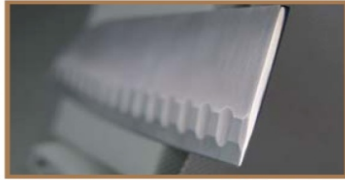

Double Hollowing Grinding



Double Hollow with Dimple



Mixed Shape Dimple



Square Dimple



Forged/Stamping Dimple

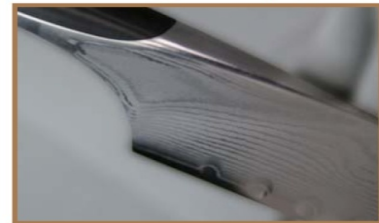

Solid Bolster with Damascus



Material: 430, 304, 420J2, 1.4116

Handle Spine

Structure: Fully forged or weld with casting/stamping parts.
Material: 430, 304, 420J2, 1.4116.

Rivet

Structure: Decorated or functional installation.
Material: 304, 430, Plated Bronze, Bronze.

Handle

Structure: Over molding, Assembly or Hot insert
Material: POM, PP, ABS, Bakelite, Wood, PS..etc

Bolster

Real Forged structure: Material here is same as the blade
Fake Forged structure: Material could be same as the blade but mostly is different with 430 or lower steel it is.

Blade Spine

Fine polish with counter radius, which could be matte or optional mirror finish.

Cutting edge

Restricted control in the thickness and edge angle to make sure the sharp life and performance.
Liquid cooling system to avoid the over heating and maintain the sharp.

Blade

Fully forged: 420J2, 1.4116
Stamping: 420J2, 1.4116, VG Damascus

Blade Tip

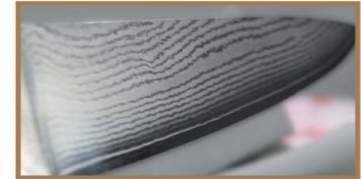

Surface : Damascus Layer



Surface : Rubber finish(Stone)

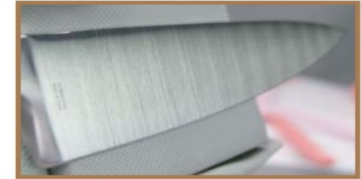

Surface: Matte finish(Hair)



Surface: Matte finish(Rain)

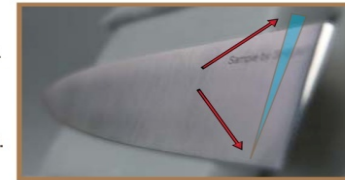

Manufacturing: Taper Grind

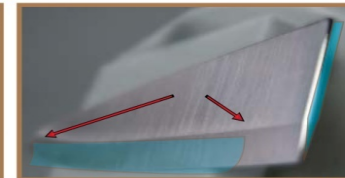

Manufacturing: Hollow Grind



Surface: Mirror(gloss)



Structure: Tang

Steel production capacity

- New product lead time: 60 days
- Lead time for reorder: 45 days
- maintain safety stock based on order forecast
- Efficiency increases by an average of 15% per year



product type	Monthly capacity	material
Real Forged Knife	200000	1. 4116, 420J2, 3CR13, 5CR15
Fake forged knife	150000	1. 4116, 420J2, 3CR13, 5CR15
Flat knife	500000	1. 4116, 420J2, 3CR13, 5CR15
Melaleuca steel	20000	VG-1
Hollow handle	20000	3CR13, 420J2

Steel products customer analysis

Country	percentage	major client
United States	70%	Calphalon, GINSU, TPC, Saber
Europe	20%	Scanpan, David Mellor, Fiskars, Lutz
other	10%	Dragonwind, B&J, GRILL CLUB MASTER

THERMOS

LERCHE

GINSU.

Calphalon

FISKARS  **GROUP**

MUTO

Products and development direction of Optoelectronics Division

Main application markets:

- medical equipment
- Ship yacht
- High-brightness special application areas

Main partners :

- Innolux、AUO、Transtouch(TTI)、EETI

Main products:

- Various touch modules(GG/GF/GFF/MM TPM)
- Fully bonded module for touch display(17~43")
- Highlight display products for special applications (high-brightness waterproof, weather-resistant and corrosion-resistant...)



Demonstration Factory of Optoelectronics Division, Zhubei

- Area: 600 square meters
- Staff: 18
- Capacity: Fully fit 30K/month
size: 17~43"
- Certification:
ISO 9001:2015

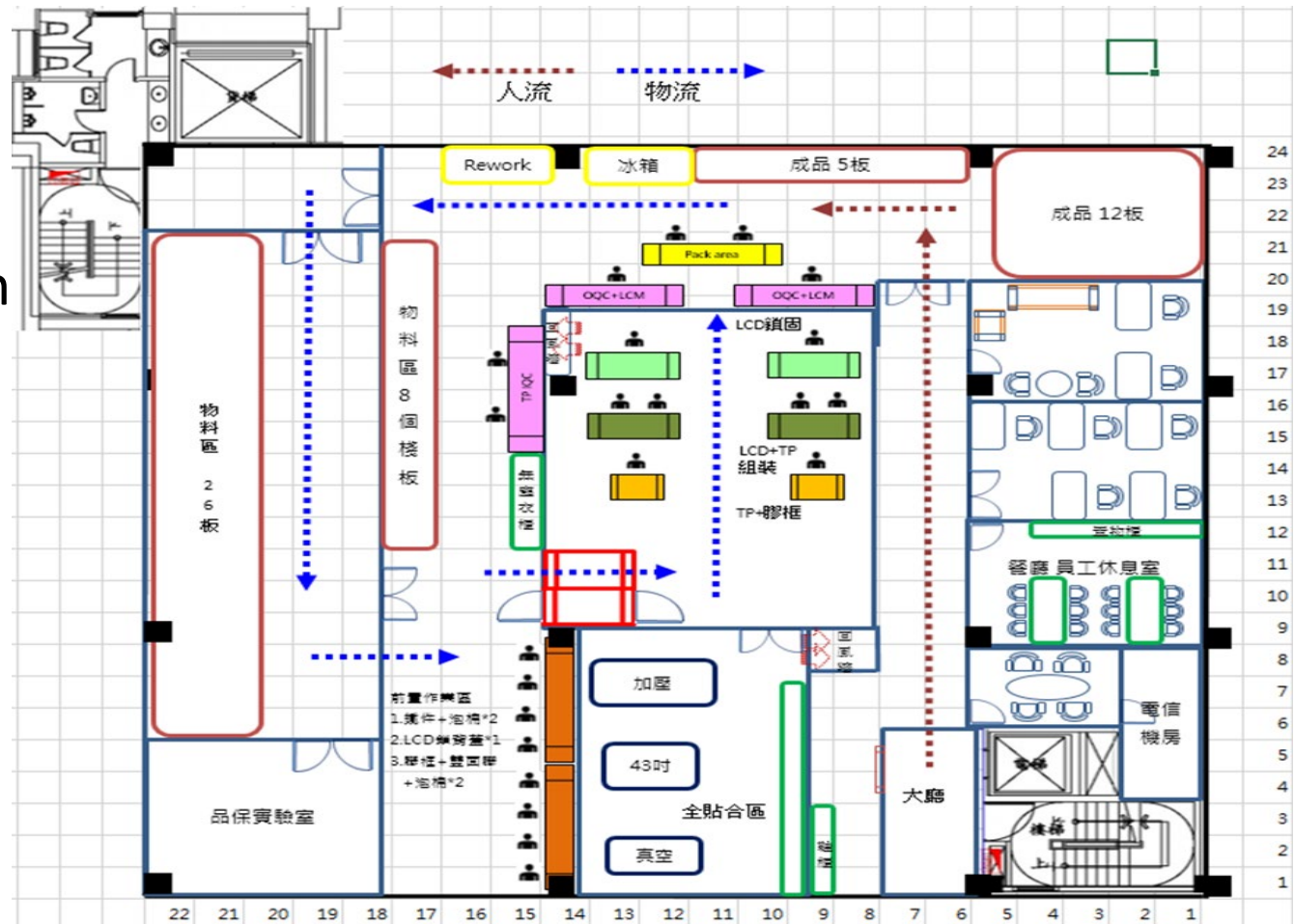

Touch related products and technology development

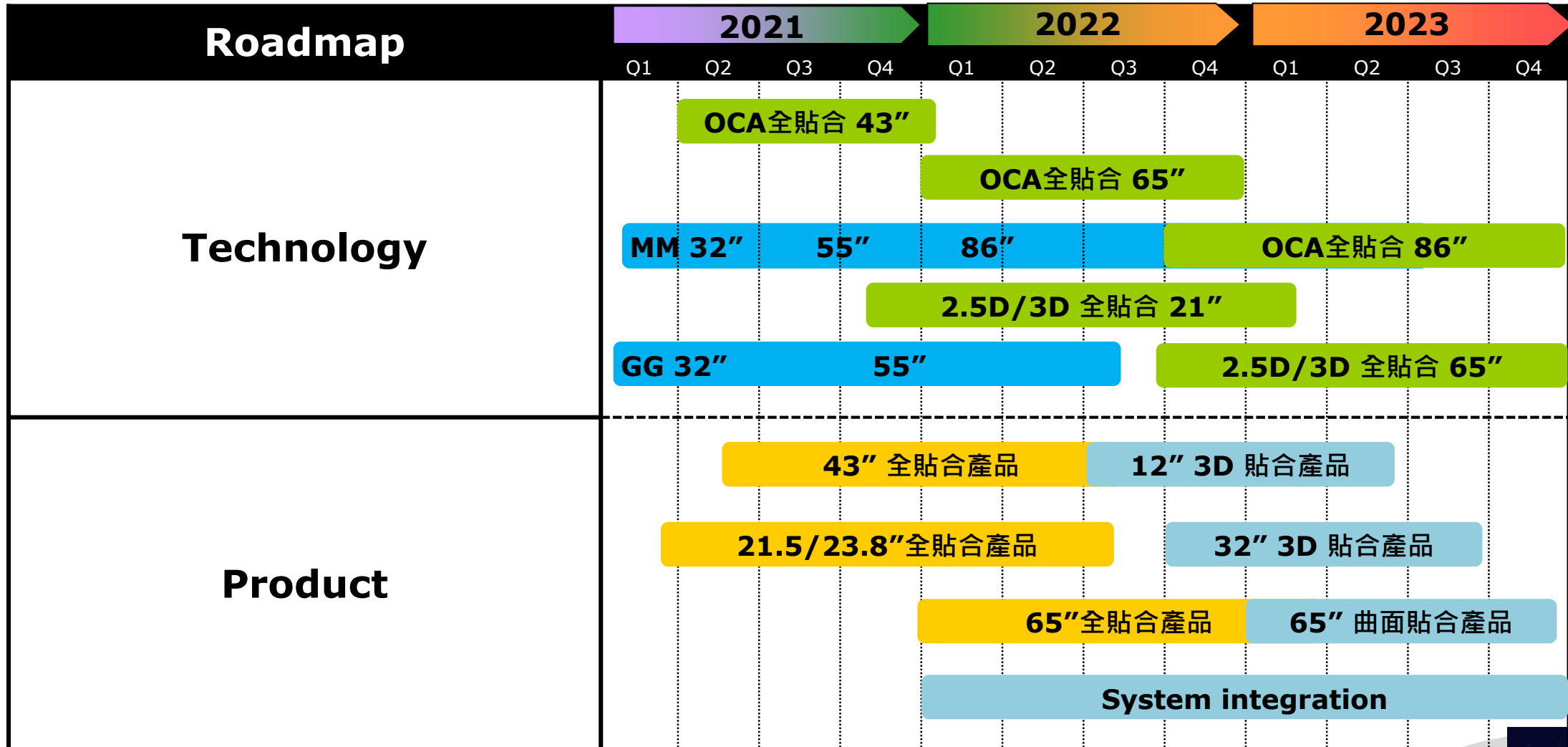

Description of the operation

The new team entered in 2020.12 and began to organize the original business very well. include:

- Settle the original foreign fund and bond investment business
- End of hard drive repair business
- Strengthen the stainless steel kitchen knife business
- Develop new business and strengthen profitability

Business strategy of steel products business: adopting the dual-track system of brand and foundry

- self-branding: China is marketed as "Master Chef Wang"; another brand, "Sheaffer", will be combined with global e-commerce marketing in the future
- In terms of foundry, undertaking OEM/ODM business of major tool brands from major European and American brands

Optoelectronics business strategy: full-fit, high-profile special application touch solution provider for medium and large sizes

- Actively develop special application fields such as sports fitness equipment, medical equipment, ships and yachts, and high brightness

expanding optoelectronic business in the near future

Cut into public works and school building power-saving business:
electromechanical, smart, energy-saving

- Construction site: Dahu Elementary School, Dahu Township, Miaoli County (10 other schools)
- Project name: Power system improvement project for primary and secondary schools in Miaoli County
- Project: Foresight Plan-Smart School-Smart Network
- Future planning: Combining optoelectronics majors, expand smart technology, actively carry out such application projects, and develop life technology products that apply smart optoelectronics

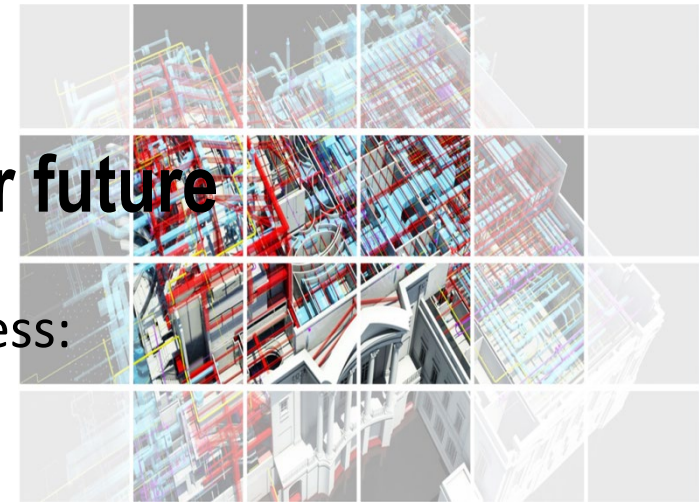

Operation Strategy Planning

The focus of recent operations of steel products:

- Strengthening the stainless steel business
- Strengthen the operation and management of Nantong Sihe's factory
- Strengthen Sun's company Nantong Sihe's ability to accept orders
- Strengthen the supply chain management of Sun's Nantong Sihe

The focus of the optoelectronic business in the near future:

- Add new projects in the optoelectronic business
- New special application touch panel project
- Participate in forward-looking infrastructure projects

Mutto Monthly Revenue Report

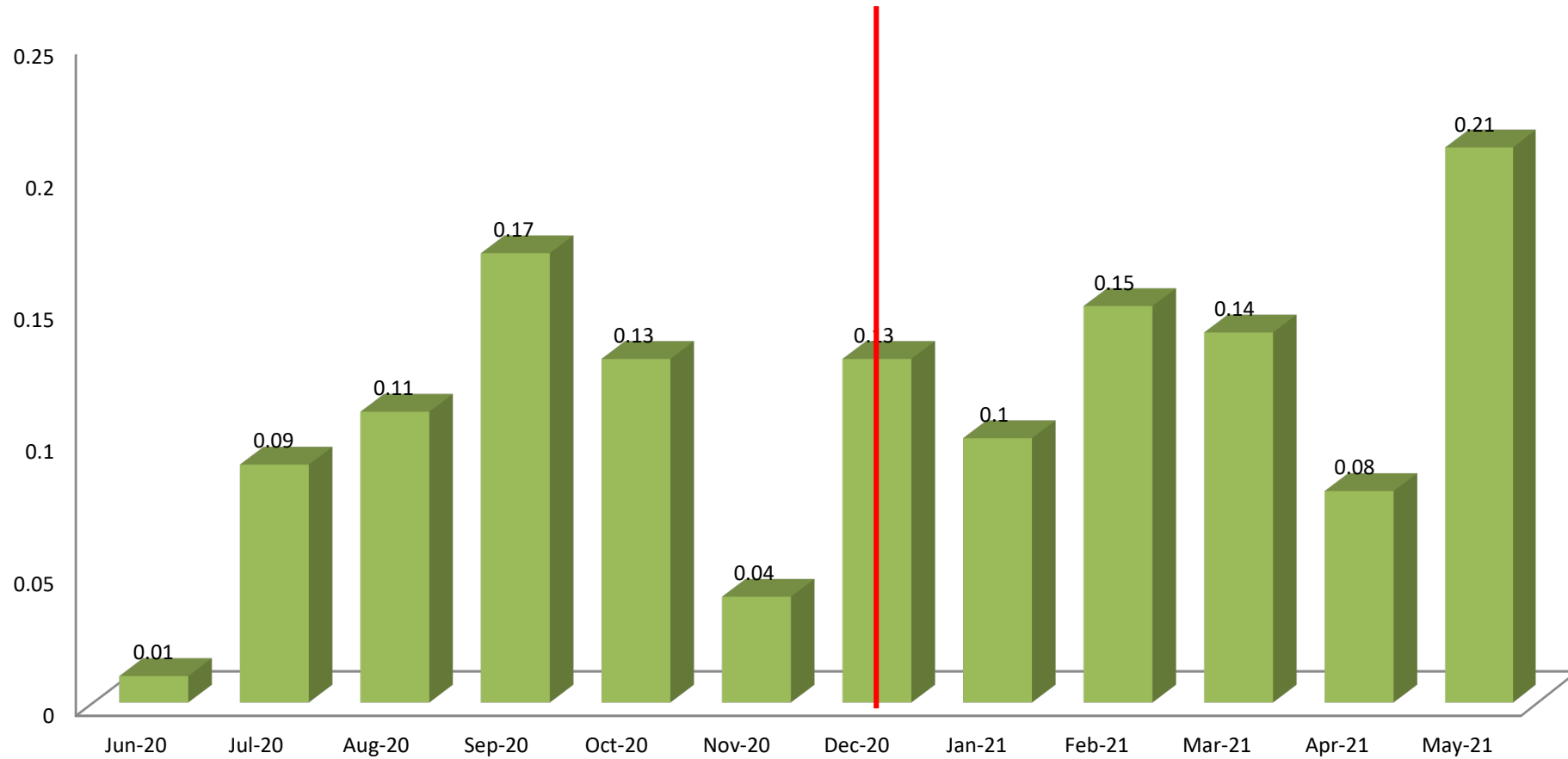



Mutto Optronics Corporation

www.muttoinc.com

Thanks for listening
END